

St Mary and Our Lady of Peace Development Project



"Upon this Summit, We Build His Church"

St Mary Remodel



Balcony: add rear windows, elevated seating, and spindled front wall for ventilation and visibility to altar.



Balcony Section

St. Mary's Catholic Church Remodel
Breckenridge, Colorado

July 07 2009



St Mary Remodel

Space behind/between churches opened up for overflow seating, meetings, education, and receptions.

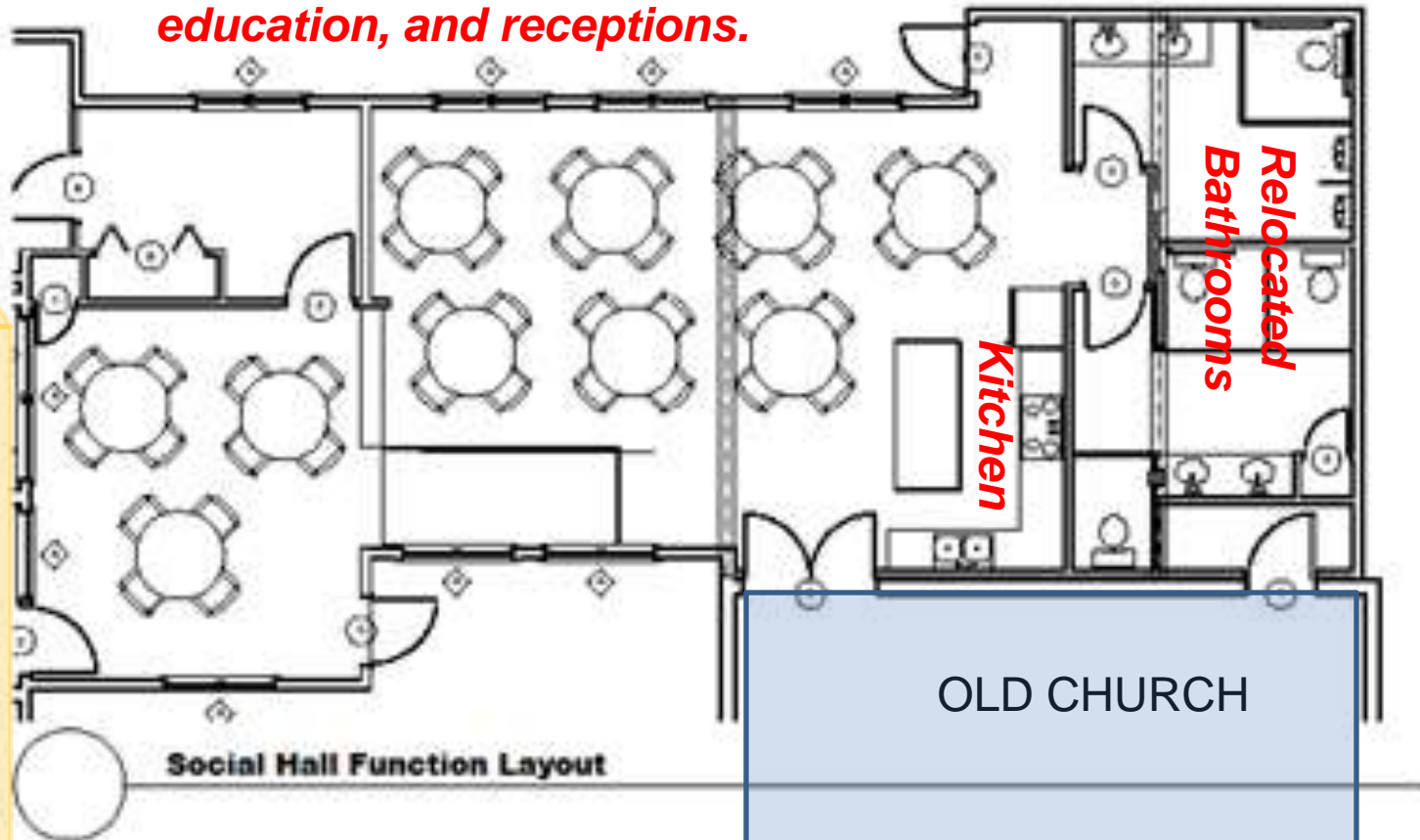

NEW
CHURCH

OLD CHURCH

"Upon this Summit, We Build His Church"

Willowbrook

Rt 9 to Kremmling



Smith Ranch Location in Town of Silverthorne

Ruby Ranch Road

Elks Lodge

"Upon this Summit, We Build His Church"





Room for future rectory

Parking for 150 cars

Southeast Entry for wind and snow protection

Proposed Site Plan Scheme 5A - Option 1 Elevations



Sanctu
Music
Total I
Future
Total S

Our Lady of Peace Catholic Church

Silverthorne, Colorado





SOUTHEAST PERSPECTIVE COMING FROM I-70, SILVERTHORNE

Proposed Our Lady of Peace Catholic Church





NORTHEAST PERSPECTIVE COMING FROM WILLOWBROOK, THREE PEAKS

Proposed Our Lady of Peace Catholic Church



Financials

New Our Lady of Peace Facility and St. Mary Remodel

OLoP 13,300 sq ft facility

Smith Ranch Property	\$	1,500,000
Construction Costs*	\$	3,700,000
Architect, Surveys, Permits, Landscaping, Fundraising, Contingency, etc.	\$	782,000
Furniture, Fixtures, and Equipment	\$	259,000
Total OLoP Costs	\$	6,241,000

St. Mary Remodel

Overflow seating, social/meeting space, balcony visibility and ventilation	\$	265,000
Total Project Costs	\$	6,506,000

Less (funds already paid or to become available)

Equity in Smith Ranch	\$	750,000	
Sale of Hammer Ranch	\$	1,318,000	
Sale of the OLoP Property less current Rectory	\$	1,845,000	
Total raised/available to date	\$	3,913,000	60%
Additional Funds Needed to Raise *	\$	2,593,000	40%

We are already more than half way there, and need to raise ~\$2.6 Million to complete this project. The faster we can start, the less expensive it will be, due to currently lower construction costs.

** Construction in 2010/2011 could save \$500,000 to \$1,000,000*

Source: Eidos Architects, Steering Committee, Capital Campaign Subcommittee
"Upon this Summit, We Build His Church"